

The World's Only  
**Patented POP Ring Technology**

**Item Description**

**\*\* Call For Sizes Not Listed \*\***

**GANG CLAMPS**



MGSSB-4-2L	1/4" - 2 LINE - SS - GANG CLAMP WITH BACK PLATE
MGSSB-4-3L	1/4" - 3 LINE - SS - GANG CLAMP WITH BACK PLATE
MGSSB-4-4L	1/4" - 4 LINE - SS - GANG CLAMP WITH BACK PLATE
MGSSB-4-5L	1/4" - 5 LINE - SS - GANG CLAMP WITH BACK PLATE
MGSSB-4-6L	1/4" - 6 LINE - SS - GANG CLAMP WITH BACK PLATE
MGSSB-4-7L	1/4" - 7 LINE - SS - GANG CLAMP WITH BACK PLATE
MGSSB-4-8L	1/4" - 8 LINE - SS - GANG CLAMP WITH BACK PLATE
MGSSB-4-9L	1/4" - 9 LINE - SS - GANG CLAMP WITH BACK PLATE
MGSSB-4-10L	1/4" - 10 LINE - SS - GANG CLAMP WITH BACK PLATE
MGSSB-4-11L	1/4" - 11 LINE - SS - GANG CLAMP WITH BACK PLATE
MGSSB-4-12L	1/4" - 12 LINE - SS - GANG CLAMP WITH BACK PLATE
MGSSB-6-2L	3/8" - 2 LINE - SS - GANG CLAMP WITH BACK PLATE
MGSSB-6-3L	3/8" - 3 LINE - SS - GANG CLAMP WITH BACK PLATE
MGSSB-6-4L	3/8" - 4 LINE - SS - GANG CLAMP WITH BACK PLATE
MGSSB-6-5L	3/8" - 5 LINE - SS - GANG CLAMP WITH BACK PLATE
MGSSB-6-6L	3/8" - 6 LINE - SS - GANG CLAMP WITH BACK PLATE
MGSSB-6-7L	3/8" - 7 LINE - SS - GANG CLAMP WITH BACK PLATE
MGSSB-6-8L	3/8" - 8 LINE - SS - GANG CLAMP WITH BACK PLATE
MGSSB-6-9L	3/8" - 9 LINE - SS - GANG CLAMP WITH BACK PLATE
MGSSB-6-10L	3/8" - 10 LINE - SS - GANG CLAMP WITH BACK PLATE
MGSSB-6-11L	3/8" - 11 LINE - SS - GANG CLAMP WITH BACK PLATE
MGSSB-6-12L	3/8" - 12 LINE - SS - GANG CLAMP WITH BACK PLATE
MGSSB-8-2L	1/2" - 2 LINE - SS - GANG CLAMP WITH BACK PLATE
MGSSB-8-3L	1/2" - 3 LINE - SS - GANG CLAMP WITH BACK PLATE
MGSSB-8-4L	1/2" - 4 LINE - SS - GANG CLAMP WITH BACK PLATE
MGSSB-8-5L	1/2" - 5 LINE - SS - GANG CLAMP WITH BACK PLATE
MGSSB-8-6L	1/2" - 6 LINE - SS - GANG CLAMP WITH BACK PLATE
MGSSB-8-7L	1/2" - 7 LINE - SS - GANG CLAMP WITH BACK PLATE
MGSSB-8-8L	1/2" - 8 LINE - SS - GANG CLAMP WITH BACK PLATE
MGSSB-8-9L	1/2" - 9 LINE - SS - GANG CLAMP WITH BACK PLATE
MGSSB-8-10L	1/2" - 10 LINE - SS - GANG CLAMP WITH BACK PLATE

**SINGLE CLAMPS**

MGSSB-4-1L 1/4" - 1 LINE - SS - GANG CLAMP



MGSSB-6-1L

3/8" - 1 LINE - SS - GANG CLAMP

MGSSB-8-1L

1/2" - 1 LINE - SS - GANG CLAMP

MGSSB-10-1L

5/8" - 1 LINE - SS - GANG CLAMP

MGSSB-12-1L

3/4" - 1 LINE - SS - GANG CLAMP

MGSSB-16-1L

1" - 1 LINE - SS - GANG CLAMP

### DUPLEX CLAMPS



MDSS-4-2L

1/4" - 2 LINE - SS - DUPLEX CLAMP

MDSS-6-2L

3/8" - 2 LINE - SS - DUPLEX CLAMP

MDSS-8-2L

1/2" - 2 LINE - SS - DUPLEX CLAMP

MDSS-12-2L

3/4" - 2 LINE - SS - DUPLEX CLAMP

MDSS-16-2L

1" - 2 LINE - SS - DUPLEX CLAMP

### CUSHION CLAMPS



MSPN4SS

1/4" - 1 LINE - SS - CUSHION CLAMP

MSPN6SS

3/8" - 1 LINE - SS - CUSHION CLAMP

MSPN8SS

1/2" - 1 LINE - SS - CUSHION CLAMP

MSPN12SS

3/4" - 1 LINE - SS - CUSHION CLAMP

MSPN16SS

1" - 1 LINE - SS - CUSHION CLAMP

### BOLTS / NUTS / WASHERS



HBSS-25-50

1/4" X 1/2" - SS - HEX BOLT FOR GANG CLAMP

HBSS-25-75

1/4" X 3/4" - SS - HEX BOLT FOR GANG CLAMP



HNSS-25

1/4" HEX NUT FOR GANG CLAMP

WASHERS

Call

### CHANNEL, STRUT & SUPPORT



Channel

1", 2", 4", 6"



Flatbar

2", 3", 4", 6"

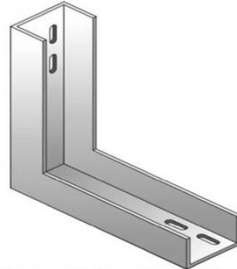

90° Short Radius Channel Elbow

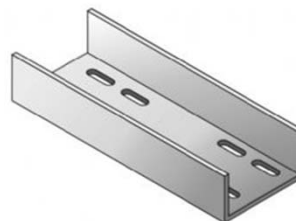

Channel Splice

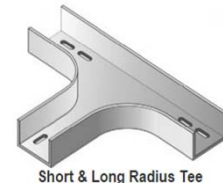

Short & Long Radius Tee



Short & Long Radius Cross



Angle

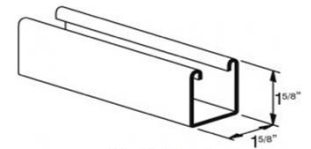

Single Strut

ADDITIONAL PRODUCTS AVAILABLE

### INSTRUMENT \* JIC \* AUTOCLAVE \* MANIFOLD



### NEEDLE VALVES \* TUBING \* BALL VALVES & ACCESSORIES



Stick Tubing



Coil Tubing



Needle Valves



Tube Benders



Ball Valves